

PORTABLE EDGEBANDER

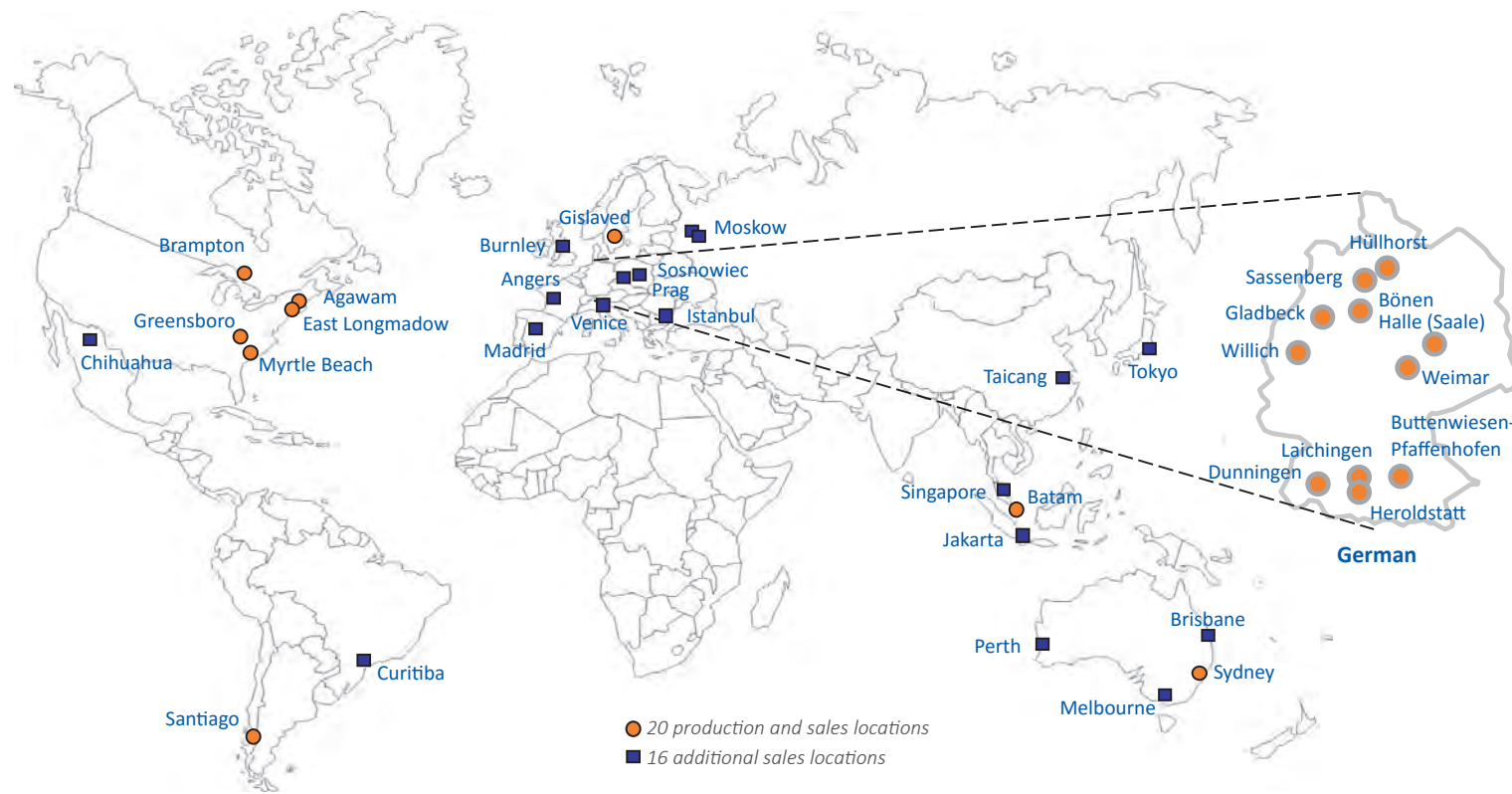

World wide presence

Our philosophy

Conserving resources and protecting the health of individuals - these are the uppermost goals. Pioneering innovations, high quality levels, extensive expertise and customer oriented service - these are the values with which Dörlken has now been synonymous for over 125 years. Together with you, we would like to look back on a company history packed with ups and downs whilst at the same time look forward to continued success for the future.

Advantages by using Doellken Edgeband

- Reduction of furniture production rejects
- Reducing customer claims
- No extra work such as 'touch up' and extra quality checks
- Improves furniture quality and design
- Makes manufacturing problem free
- Increased production speed & output makes delivery time faster

**Summary: Less problems = Saving money
Higher Turnover = Making more money.**

SINGAPORE

SURTECO ASIA HEAD OFFICE - SURTECO PTE.,LTD
25 International Business Park, #02-70/71 German Centre, Singapore 609916
Phone: +65 62260669 - Fax: +65 62260797 - info@sg.surteco.com - www.sg.surteco.com

JAPAN

SURTECO JAPAN Branch - SURTECO PTE., LTD.
403 Satellite 6 Building 4F
1-3-68 Gamou-nishimachi,
Koshigaya, Saitama 343-0835 Japan
Phone:+81-(0)48-954-5269 - Fax : +81-(0)48-954-5294
Mobile: 080-5006-0752 - surteco-japan@vega.ocn.ne.jp

INDONESIA

PT Doellken Jakarta Branch
Griya Sinta Building
Tomang Raya No. 39, 3rd floor # 3C,
Jakarta Barat 1140
Phone: + 62 21 56941368
Fax: +62 21 29676060

DÖLLKEN

A SURTECO BRAND



DÖLLKEN

A SURTECO BRAND

PORTABLE EDGE BANDER

Multinational Patented
PORTABLE EDGE BANDER

DÖLKEN

A SURTECO BRAND

The integration of world lightest, most compact, highest performance portable edgebander

- Custom alignment for use on straight or curved panels.
- Automatically applying glue on the tape and amount of the glue applied could be easily adjusted.
- Suitable for portable or stationary application.
- Quick and easy use by a single operator.
- Variable speed feed / Digital temperature control / Reheat quickly.
- Minimum inner radius : 25mm (1 inch)

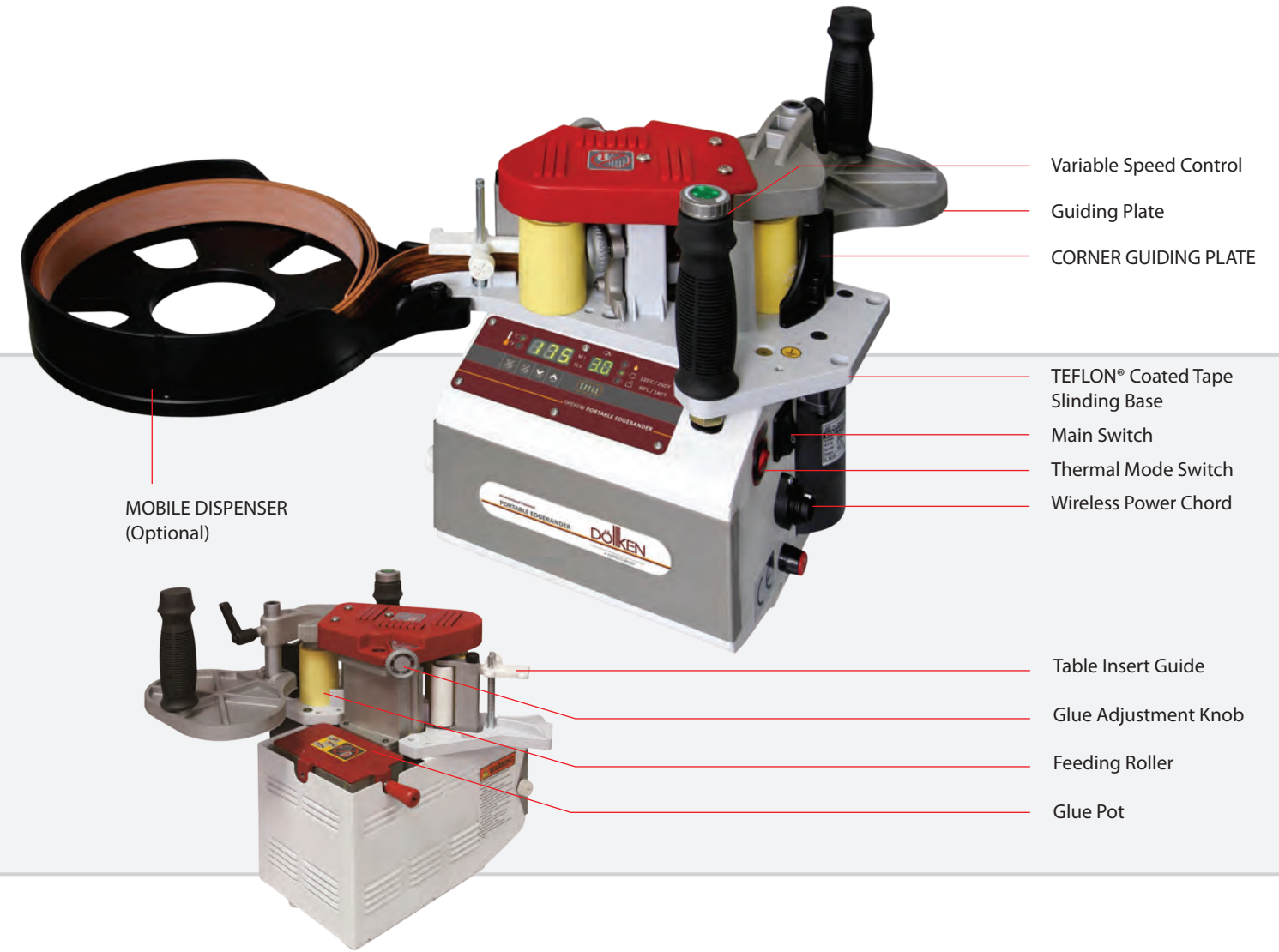

DPE65W ➤
WIRELESS PORTABLE
EDGE BANDER



➤ Tape thickness could be easily adjusted to operate edging from 0.4 - 3 mm.



➤ Easy entrance feeding guide allow quick tape width measurement

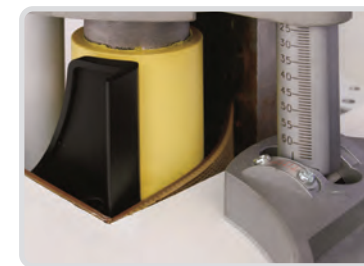

➤ CORNER GUIDING PLATE allows precise corner edging with ease.



➤ Digital display & temperature control.



DPE65 ➤
WIRELESS PORTABLE
EDGE BANDER



➤ The Glue adjustment knob is situated on top avoid interference during operation.



➤ Perfect performance on glue application. Double adhesive is not necessary



➤ Easy entrance feeding guide allows quick tape width measurement.
➤ Tape widths :10- 65 mm
Guiding plate can be tilted within 15 degree for bevel edge banding



➤ Easy handle speed adjustment enhance operation efficiency



DPE45 ➤
PORTABLE EDGE BANDER

SPECIFICATION



Model Specification	DPE45	DPE65	DPE65W
Gross weight - Standard Case (Cruiser Case)	10.7 kg	11.1 kg	12.0 kg
Net weight	8.4 kg	8.8 kg	9.8 kg
Machine Size	360 x 310 x 350 mm	250 x 190 x 350 mm	
Output Power with Motor	855 W	840 W	
Glue pot capacity	150 ml	400 ml	
Warm-up Time	6 mins (120°C / 250°F)	4 mins (120°C / 250°F)	
Working temperature	120°C - 200°C (250°F - 390°F)	MODE 1: 120°C - 200°C (250°F - 390°F) MODE 2: 80°C - 155°C (175°F - 310°F)	
Feeding Speed	2 - 6 M/min.(6.5 - 20 Ft/min)	2 - 6 M/min.(6.5 - 20 Ft/min)	
Tape Thickness		0.4 - 3 mm	
Tape Width	10 - 45 mm	10 - 65 mm	
Temp. Control	o	-	o
Digital display & Control	o	o	o
Speed Control	o	o	o
Wireless banding	-	o	o
Packing Size - Standard Case (Cruiser Case)	350 x 300 x 375 mm / 576 units (20' Container) 415 x 460 x 540 mm / 280 units (20' Container)		

DPE45 PORTABLE EDGE BANDER



MACHINES COMPARISON: OTHER BRAND VERSUS DOELLEN DPE65

OTHER BRAND Supporting Plate DPE65

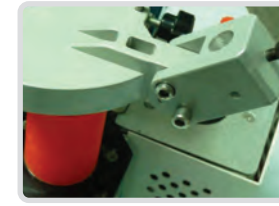

No incline indicator, difficult adjust precisely to desire angle, maximum approximate angle : 60°



1. Incline angle indicator
2. Height adjustment Indicator
3. Wider adjustment angle up to 30°

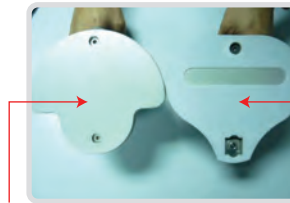

Possible damage might occur with direct contact to workpiece surface

Supporting plate is enhanced with PVC protection to avoid damage workpiece surface.

OTHER BRAND Tape insert and Setting DPE65



No measurement indication.



Height measurement indicator.

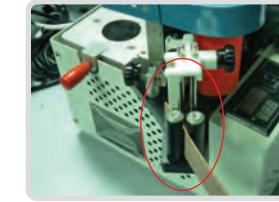

Without guiding feature could missed the entrance when inserting tape.



Tape entrance guiding (Patented)

OTHER BRAND Thickness Adjustment DPE65



Adjustment required for different thickness



Thickness has been pre-adjusted at the optimum condition in factory setting. Adjust thickness device only during special occasion (Extra thin edge band).



Designed defect, the bottom fall out easily.

OTHER BRAND Safety Devise DPE65



Before power out, heating lights are on



After power recovery, machine switched off heating.

Remark: when encountered power outage, if machine does not equipped with power outage protection devise, machine could continue heats up after power recovery and might cause damage to the machine or even case of fire, this would not be qualified for safety regulation.

Glue Application

DPE65

T: 3 mm
W: 40 mm



Glue application even

T: 1 mm
W: 44mm

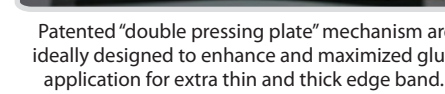

Glue application even

Patented "double pressing plate" mechanism are ideally designed to enhance and maximized glue application for extra thin and thick edge band.

OTHER BRAND

T: 3 mm
W: 40 mm



Glue could not be applied on to thicker edge band

T: 1 mm
W: 44mm

Glue not perfectly even

OTHER BRAND Heating Protection Devise DPE65



Not qualified to meet safety regulation by not include mechanical protection devise for heating tank, could possibly cause machine burnt out by continuous heat when encounter malfunctioning.



Heating tank is mandatory to equipped with mechanical protection devise, to provide secondary protection which is required by the safety regulation.

ACCESSORIES

MOBILE DISPENSER > BC25

- > Prevent possible damage to hanging long edging.
- > Easy clip on design and could hold up edge band from height 10-62mm, thickness 0.4-3.0mm



ELECTRIC CLAMPING KIT > DEC03 (Standard with cruiser case)

- > Powerful vacuum pump suitable for different series.
- > Power outage prevention design.
- > Horizontal and Vertical clamping -30° - 90°



VACUUM CLAMP SET > DVC03 (Standard with cruiser case)

- > The clamps will instantly detach when pressure released from the handle



STATIONARY WORKTABLE > DT95

- > Edgebanders and edgeband trimmers installed onto the stationary worktable ensure accurate application on small, thin, or curved workpieces not suitable for use with vacuum clamp.
- > An embedded outlet and magnetic switch provides a convenient on/off functionality on the edgebander or edgeband trimmer during operation.



VACUUM HANDLES > VH11 (Optional)



TRIMMER ADAPTOR PLATE > ST15 (Optional)



- > Easy installation onto edgebander and edgeband trimmer cruiser case.
- > Ensures fast and secure tightening and a strong grip of large panels for edge banding avoiding scratches and damage on the panel surface.
- > When the working table can not be attached via vacuum clamp, a vacuum kit can be secured to the edge of the working table using c-clamps or screws.

TAPE DISPENSER > BC99

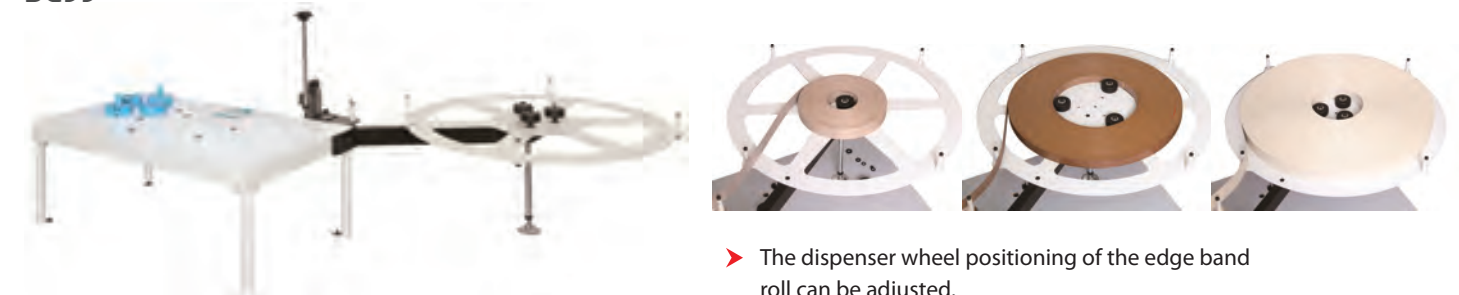

- > The dispenser wheel positioning of the edge band roll can be adjusted.

DUAL END CUTTER > DC65



- > A unique two-point support design ensures perfectly connected and aligned cuts.
- > Ergonomic design handle bar.

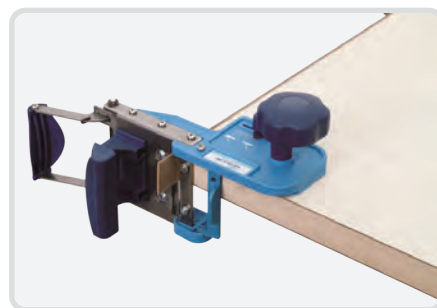

- > Adjustable cutting line compensation design ensures precise end-to-end cuts.



- > The frame maybe opened to measure perpendicular and uniform ends cuts.

GUIDE COMPONENT KIT > ST97



- > Assists with keeping workpiece on level plane while straightline edgebanding or trimming.

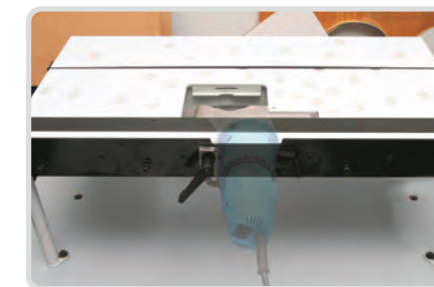

- > Floating adjustment device to enhance more precise straightline trimming.

DOUBLE-SIDE TRIMMING KIT > DST88



- > Suitable for width from 10 - 65mm edging.
- > Straight-line floating suspension design provide precise trimming result.